

**State FFA Nursery/Landscape Practicum 1987**  
**Agricultural Education Curriculum Office**

**NOTE:** In photocopying, the drawing is slightly stretched (about 1% or 0.1" for every 10"). Measurements on the plan to the closest one-half-foot equivalent are satisfactory for all calculations. When printing, you must make sure that the printer is NOT set on "Fit to Page" and that it is set on "Print as Image." This is the only way that both the questions and the map will print out correctly.

**DIRECTIONS:** The following questions relate to the landscape plan provided.

1. What is the best plant for area A?
 

A. Dwarf Nandina	C. Sweet Gum
B. Yaupon Holly	D. Ligustrum
  
2. How wide is the proposed walk? Measure the walk at the point the walk and drive meet.
 

A. 3 ft.	B. 4 ft.	C. 5 ft.	D. 6 ft.
----------	----------	----------	----------
  
3. The designer forgot to specify a plant for area B. Based on the drawing, which category of plants did she intend to select a plant from for this area?
 

A. groundcovers	C. upright shrubs
B. flowering shrubs	D. small trees
  
4. How many pots of liriopse will be required to plant area C if they are to be planted 12" O.C.?  

A. 35	B. 75	C. 150	D. 175
-------	-------	--------	--------
  
5. What plant listed below would be best for area D?
 

A. Red Tip Photinia	C. Dwarf Yaupon Holly
B. Dwarf Nandina	D. Waxleaf Ligustrum
  
6. Which area will get sun in the late afternoon?
 

A. the grass area between the walk and residence	C. the driveway
B. the deck	D. plant D
  
7. What is the area of the deck, using outside measurements?
 

A. 100 sq ft	B. 170 sq ft	C. 240 sq ft	D. 265 sq ft
--------------	--------------	--------------	--------------
  
8. What is the cost of the rail fence for the climbing roses if the fence costs \$5 per linear foot?
 

A. \$35	B. \$95	C. \$159	D. \$259
---------	---------	----------	----------
  
9. How many square feet of sod will be required to cover the grassed area between the walk and the house?
 

A. 109	B. 200	C. 370	D. 598
--------	--------	--------	--------
  
10. What is wrong with the group of azaleas?

- A. they are not in a bed
- B. they will be hard to maintain

- C. they will get too much rain
- D. all the above

## ANSWER KEY

1. A
2. B
3. A
4. A
5. C
6. B
7. C
8. B
9. C
10. D

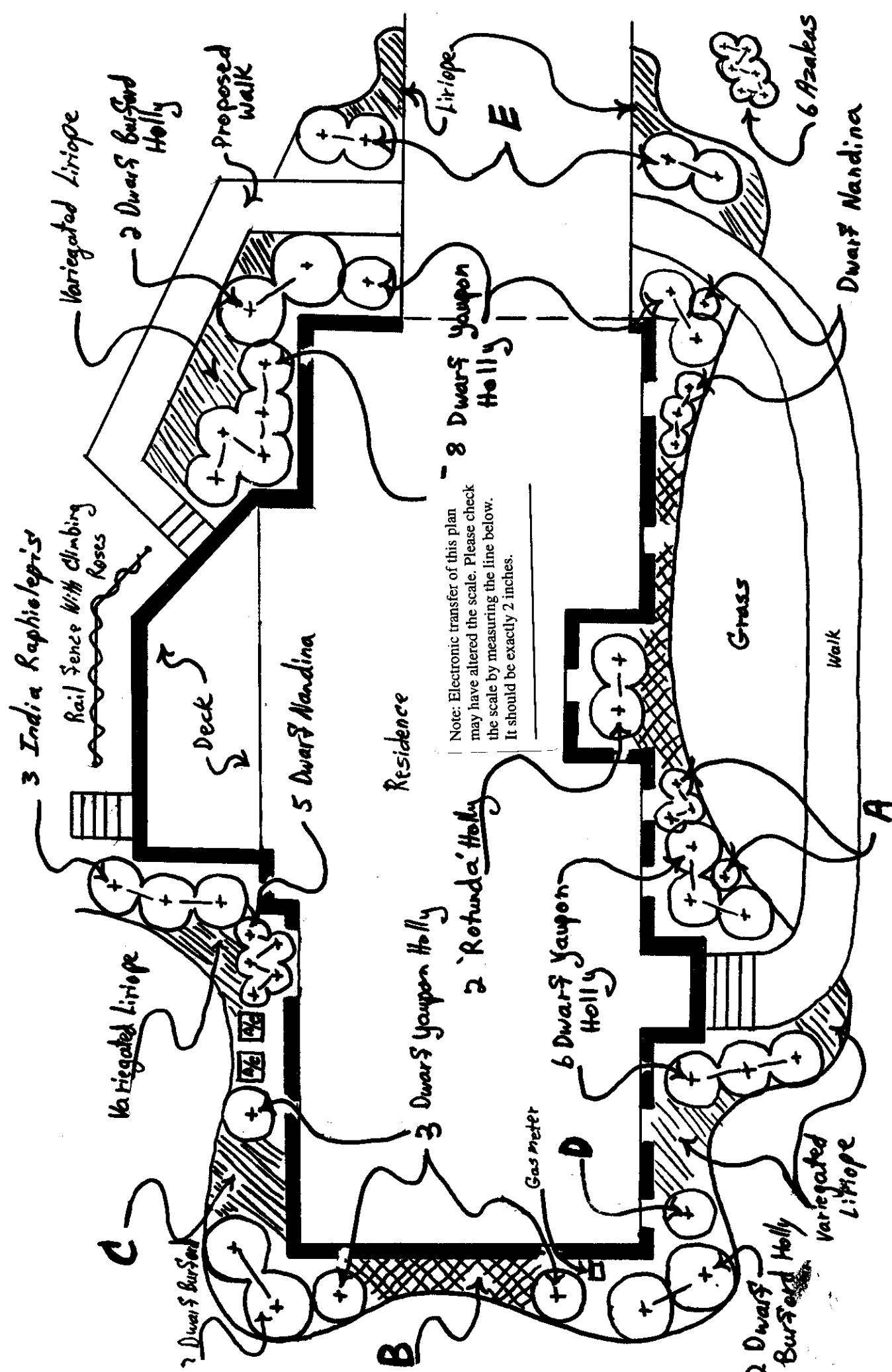

Note: Electronic transfer of this plan may have altered the scale. Please check the scale by measuring the line below. It should be exactly 2 inches.

---



Scale: 1"=10'

**STATE FFA NURSERY/LANDSCAPE CONTEST**

**LANDSCAPE PRACTICUM**

1987